

カムストロークプレート

25°30°コンパクトタイプ

CAM STROKE PLATE

CSPWL (銅合金タイプ)

CAD
FILE

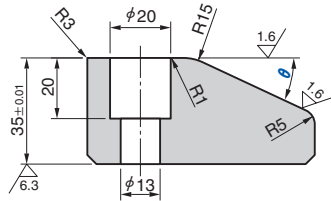
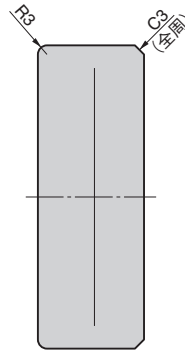
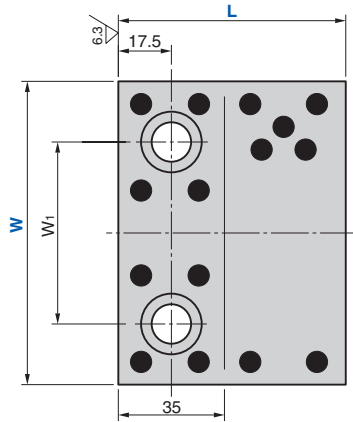

〈材質〉 SO#50SP2

●スライド方向



Catalog No.	W	L	θ	W ₁
CSPWL	100	75	25	60
			30	
	150		25	110
			30	



Catalog No. W - L - θ
CSPWL 100 - 75 - 25

CSPSL (スチールタイプ)

CAD
FILE

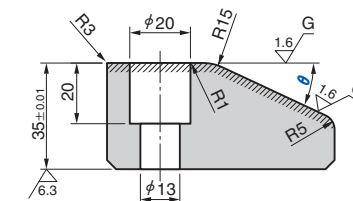
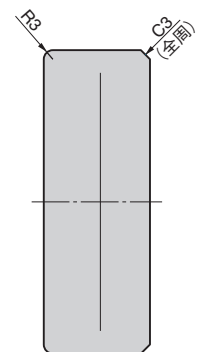
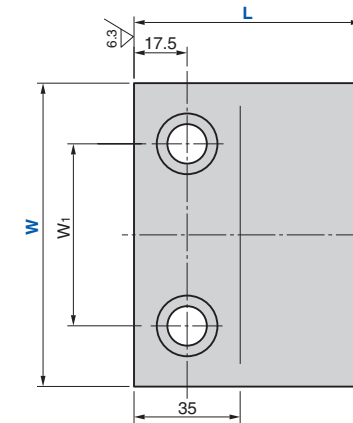

〈材質〉 SK85
////部高周波焼入れ
硬さ HRC55~

Catalog No.	W	L	θ	W ₁
CSPSL	100	75	25	60
			30	
	150		25	110
			30	



Catalog No. W - L - θ
CSPSL 100 - 75 - 25

カム用スライド部品