

### AERIAL CAM UNIT

グレード	加工力 kN (tonf)			ストローク	Catalog No.	W	θ	圧力源 PS
	100万回 標準	100万回 条件付	30万回 条件付					
White	14.7(1.5)	22.1(2.2)	29.4(3.0)	Long	VACWL	46	00~50 (5°ピッチ)	ISO ISOL

ISO,ISOL:Coil Spring

・オーダー方法が変わり圧力源について、ISOまたは、ISOL:Longlifeタイプをご指定ください。



Catalog No.	W	θ	PS	Option
VACWL	46	10	ISO	
VACWL	46	10	ISOL	SC60



オプションコード	仕様
SC	マウント面長を1~60mmの範囲(指定1mm単位)で前方に伸ばします。

#### ■スプリング力

●ISO仕様

θ	初圧		終圧		使用 スプリング
	N	kgf	N	kgf	
00	108	11	1140	116	TJM25-139
05	154	15.7	1140	116	TJM25-139
10	222	22.7	1140	116	TJM25-139
15	118	12.1	1075	110	TJM25-127
20	144	14.6	1075	110	TJM25-127
25	169	17.2	1075	110	TJM25-127
30	194	19.8	1075	110	TJM25-127
35	219	22.4	1075	110	TJM25-127
40	244	24.9	1075	110	TJM25-127
45	244	24.9	1075	110	TJM25-127
50	269	27.5	1075	110	TJM25-127

●ISOL仕様

θ	初圧		終圧		使用 スプリング
	N	kgf	N	kgf	
00	76	7.8	805	82.2	TJL25-139
05	109	11.1	805	82.2	TJL25-139
10	157	16.0	805	82.2	TJL25-139
15	83	8.5	756	77.1	TJL25-127
20	101	10.3	756	77.1	TJL25-127
25	119	12.1	756	77.1	TJL25-127
30	136	13.9	756	77.1	TJL25-127
35	154	15.7	756	77.1	TJL25-127
40	172	17.5	756	77.1	TJL25-127
45	172	17.5	756	77.1	TJL25-127
50	189	19.3	756	77.1	TJL25-127

#### ■カムストローク

θ	ストローク mm
00	28.9
05	30.5
10	31.1
15	32.2
20	34.1
25	36.0
30	38.0
35	40.1
40	42.4
45	46.5
50	49.8

#### ■重量\*1

θ	全重量 kg	カムスライダ重量 kg	取付工具重量*2 kg
00	5.6	2.0	2.0
05	5.6	2.0	2.0
10	5.6	2.0	2.0
15	5.5	2.0	2.1
20	5.4	2.0	2.1
25	5.4	2.0	2.2
30	5.3	2.0	2.3
35	5.3	2.0	2.4
40	5.3	2.0	2.6
45	5.3	2.0	2.8
50	5.4	2.0	3.3

\*1 上記数値は、SCオプション無しの場合です。SCオプション有りの場合はスライダ重量が増えます。取付工具重量を軽減してください。

\*2 取付工具重量は目安値です。厳密にはプレス速度により変わります。

#### ■後方抜きスペース

θ	L mm
00	28.6
05	34.0
10	38.2
15	46.6
20	55.3
25	62.5
30	70.1
35	68.1
40	71.7
45	80.6
50	83.9

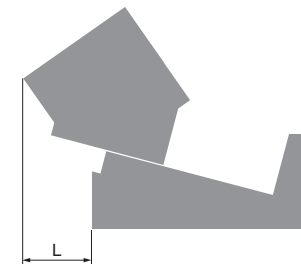

### AERIAL CAM UNIT

VACWL46-00



VACWL46-05



● Cam Diagram

● Cam Diagram

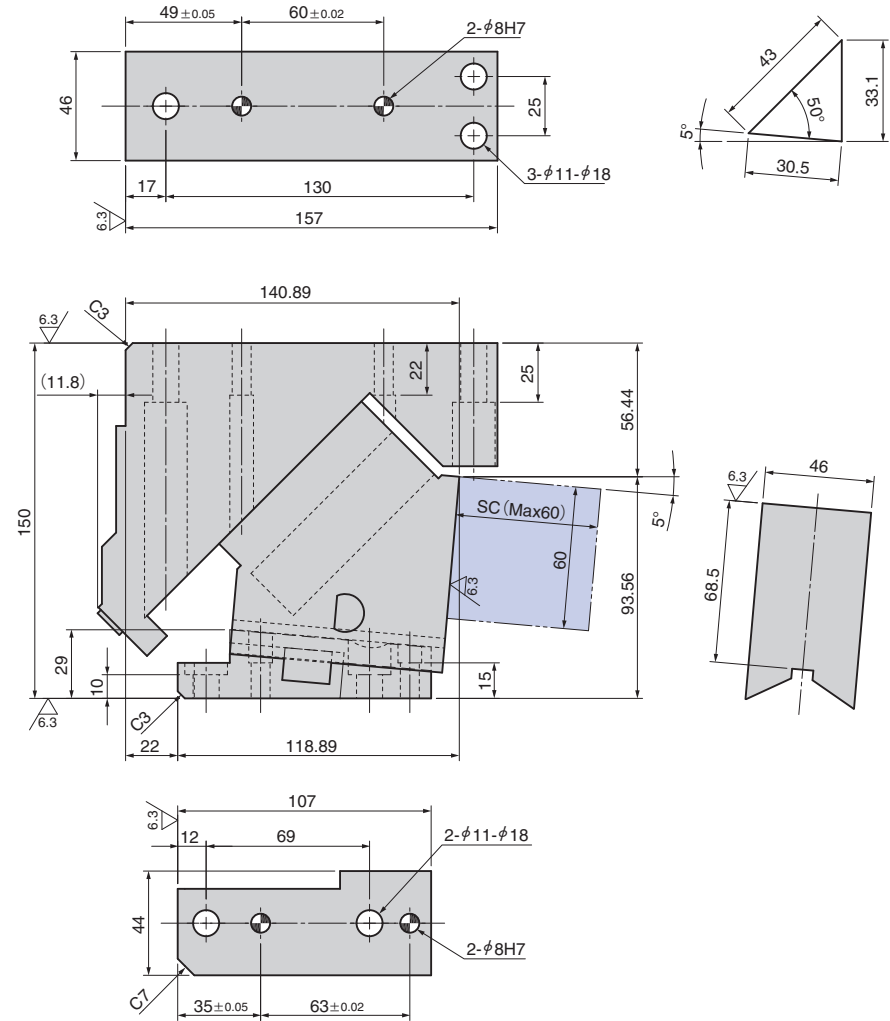
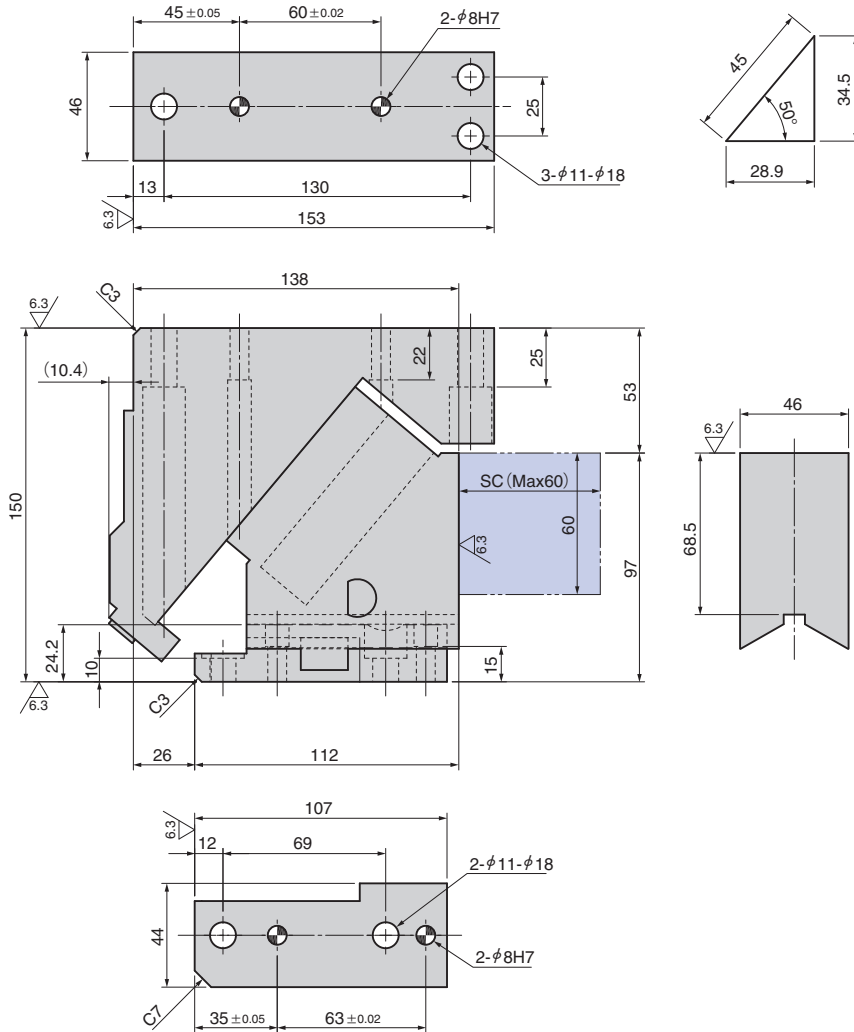

▶ 部品表P.391参照。

▶ 部品表P.391参照。

### AERIAL CAM UNIT

VACWL46-10



VACWL46-15



● Cam Diagram

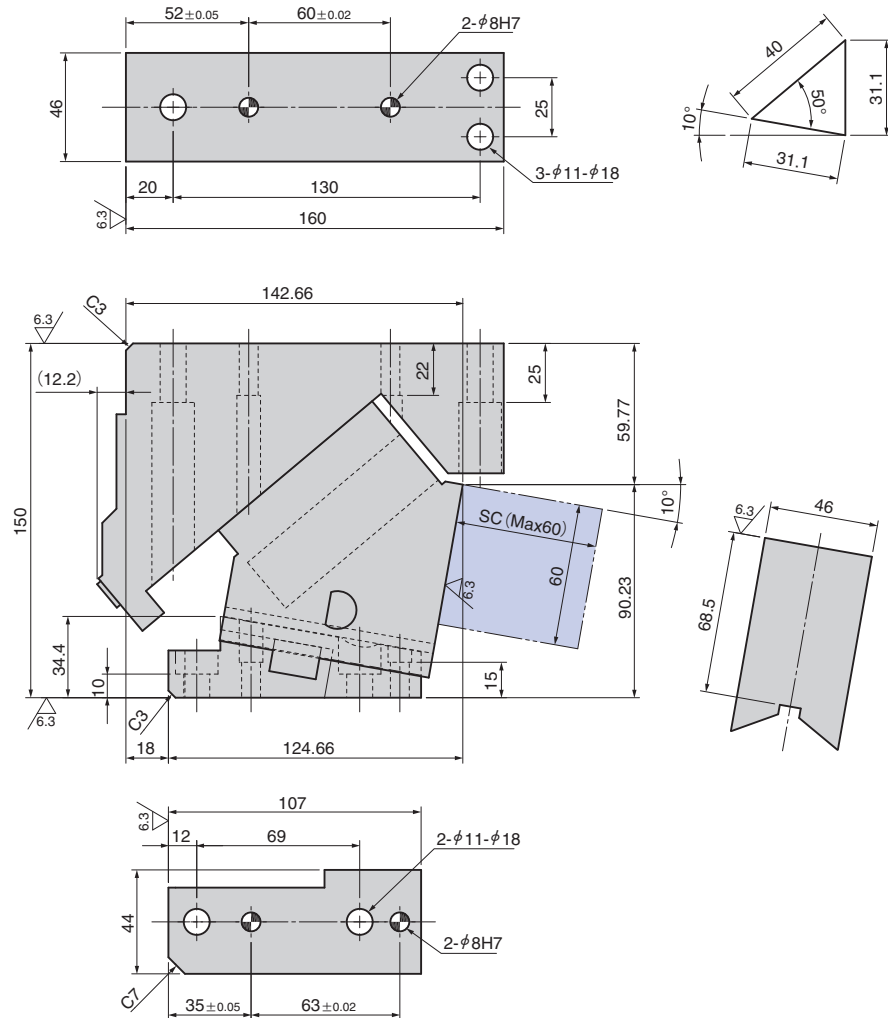

● Cam Diagram

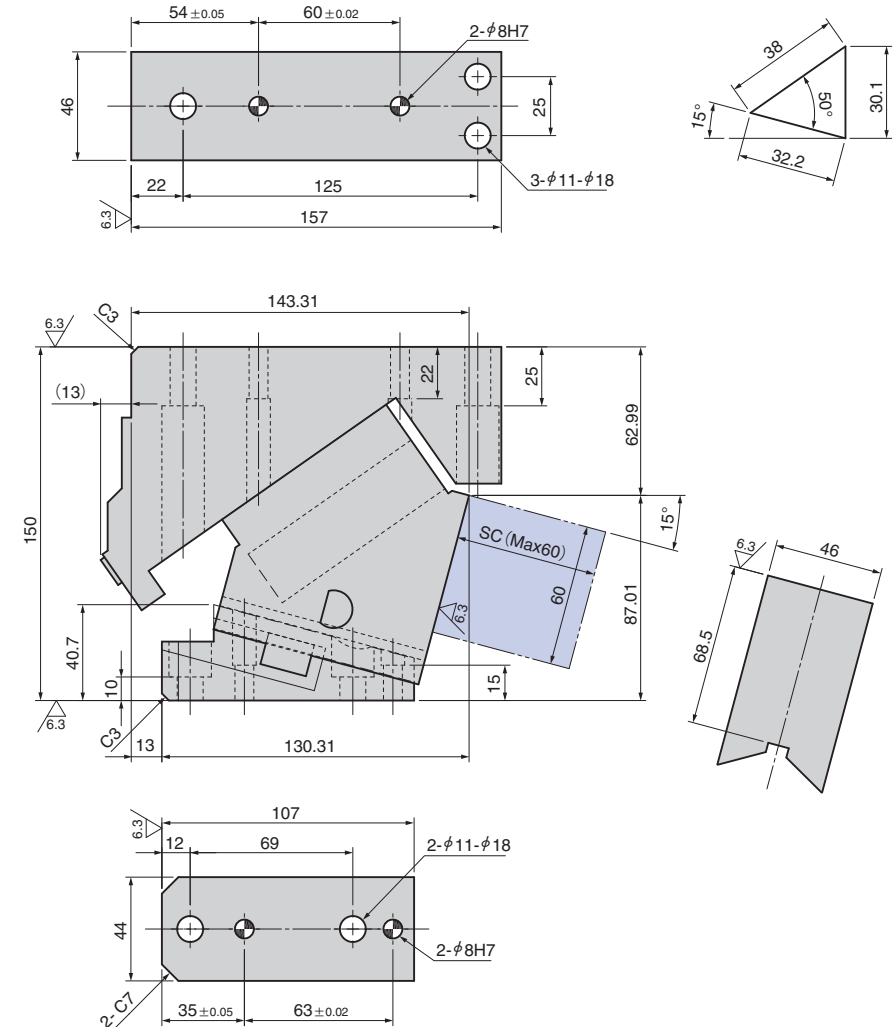

### VACWL46-20



### VACWL46-25



● Cam Diagram

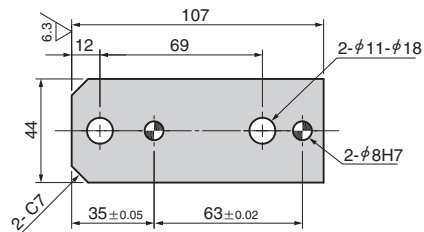
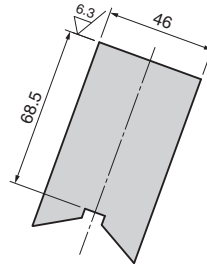
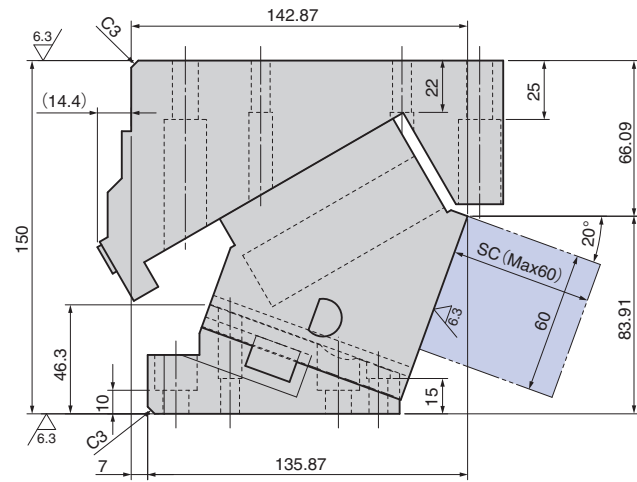
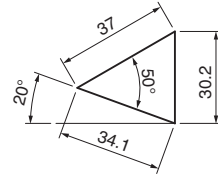
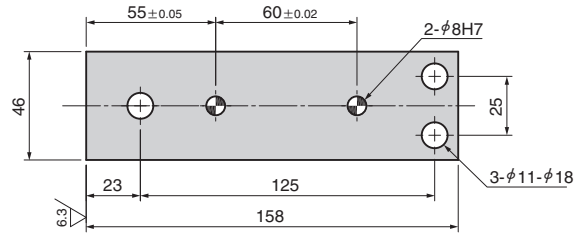

● Cam Diagram

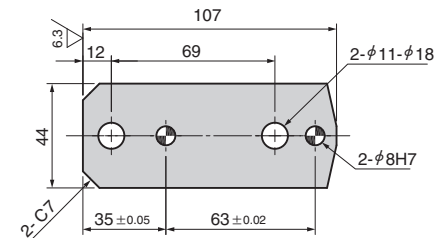
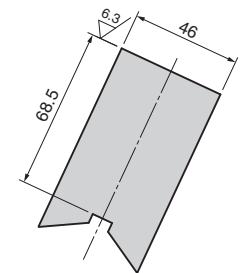
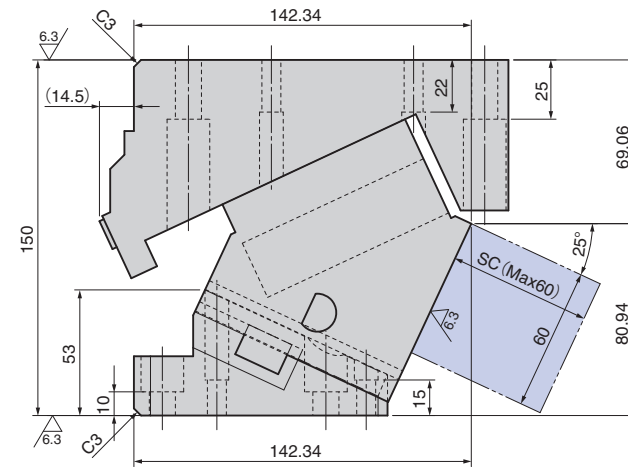
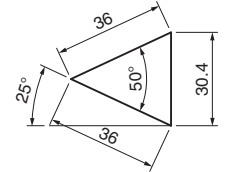
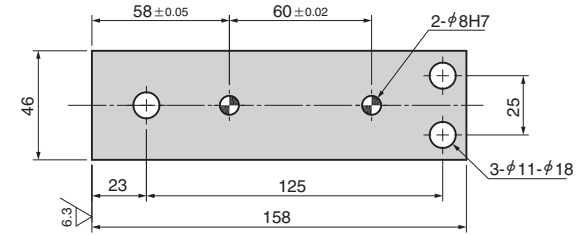

### AERIAL CAM UNIT

VACWL46-30



VACWL46-35



● Cam Diagram

● Cam Diagram

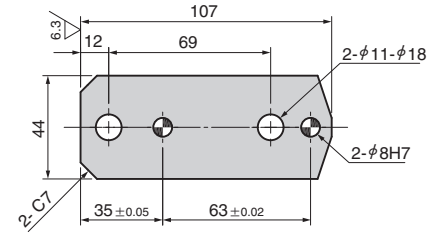
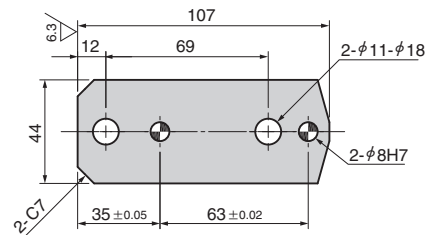
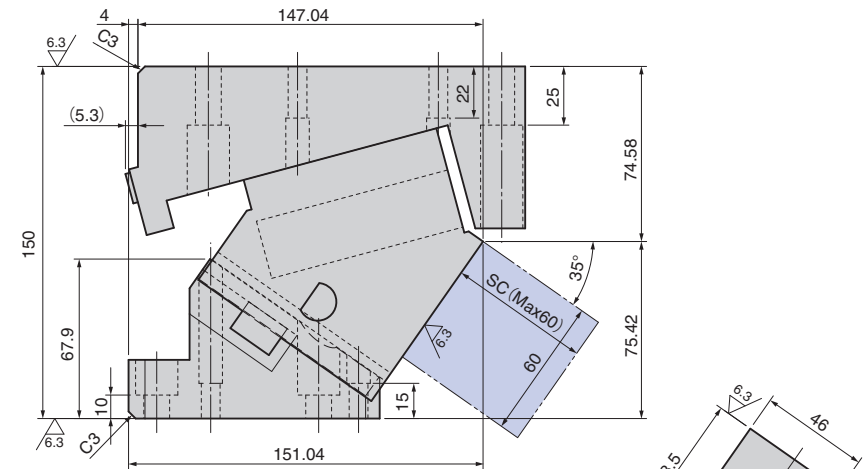
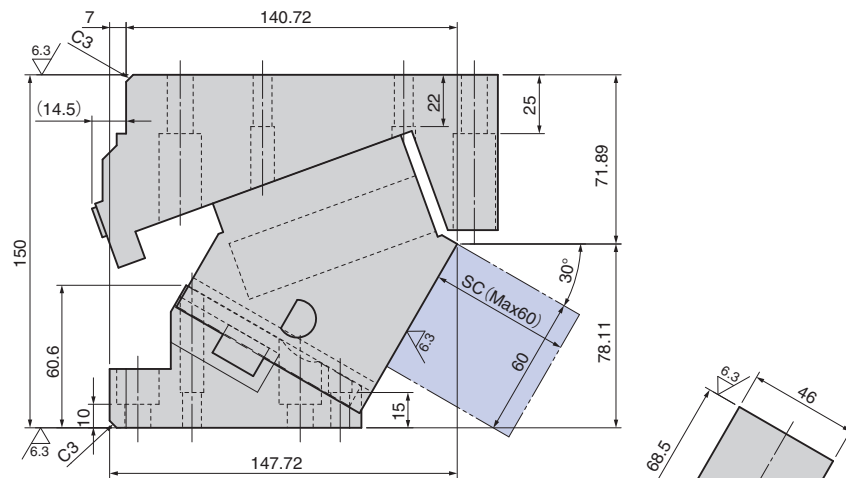
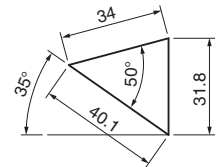
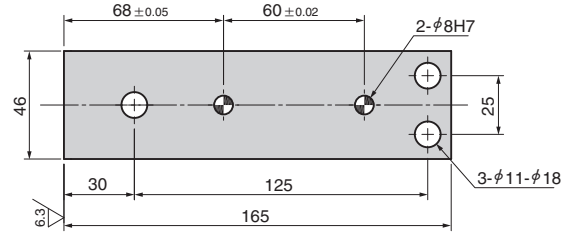
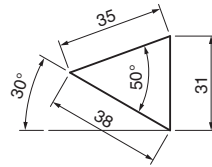
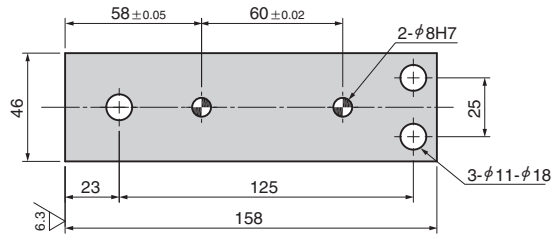

▶ 部品表P.391参照。

▶ 部品表P.391参照。

## AERIAL CAM UNIT

VACWL46-40



VACWL46-45



● Cam Diagram

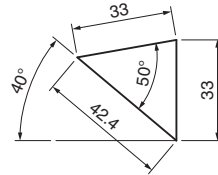
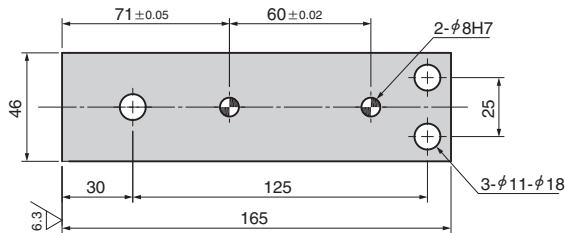

● Cam Diagram

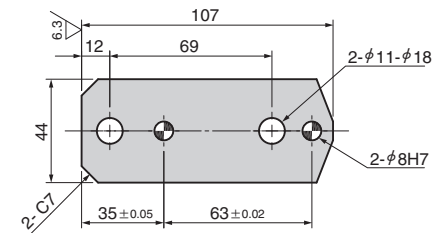
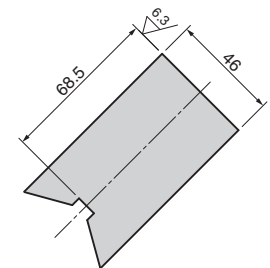
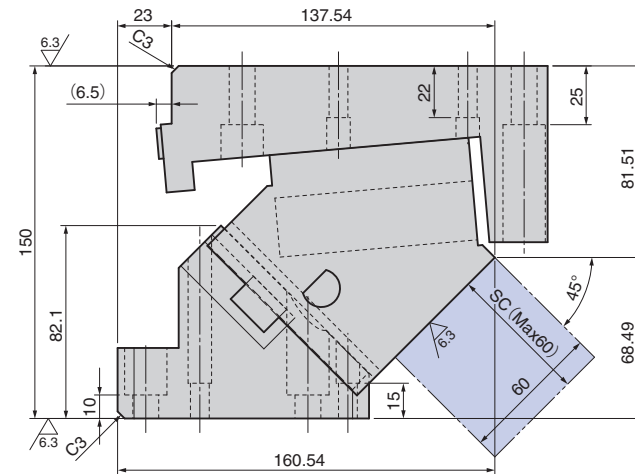
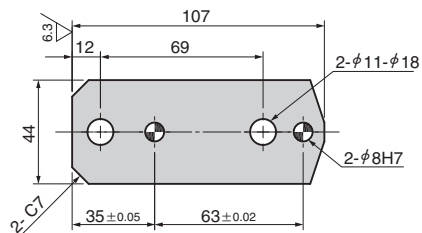
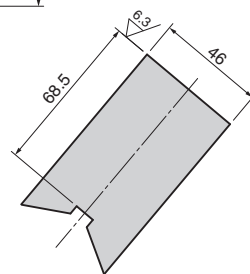
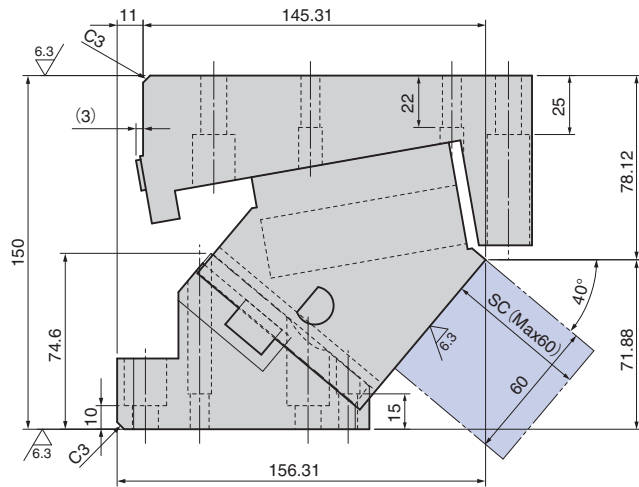
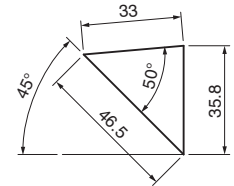
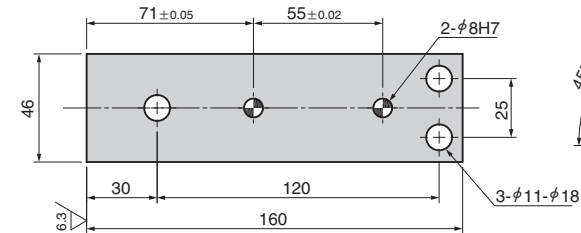

部品表P.391参照。

部品表P.391参照。

## AERIAL CAM UNIT

VACWL46-50



● Cam Diagram

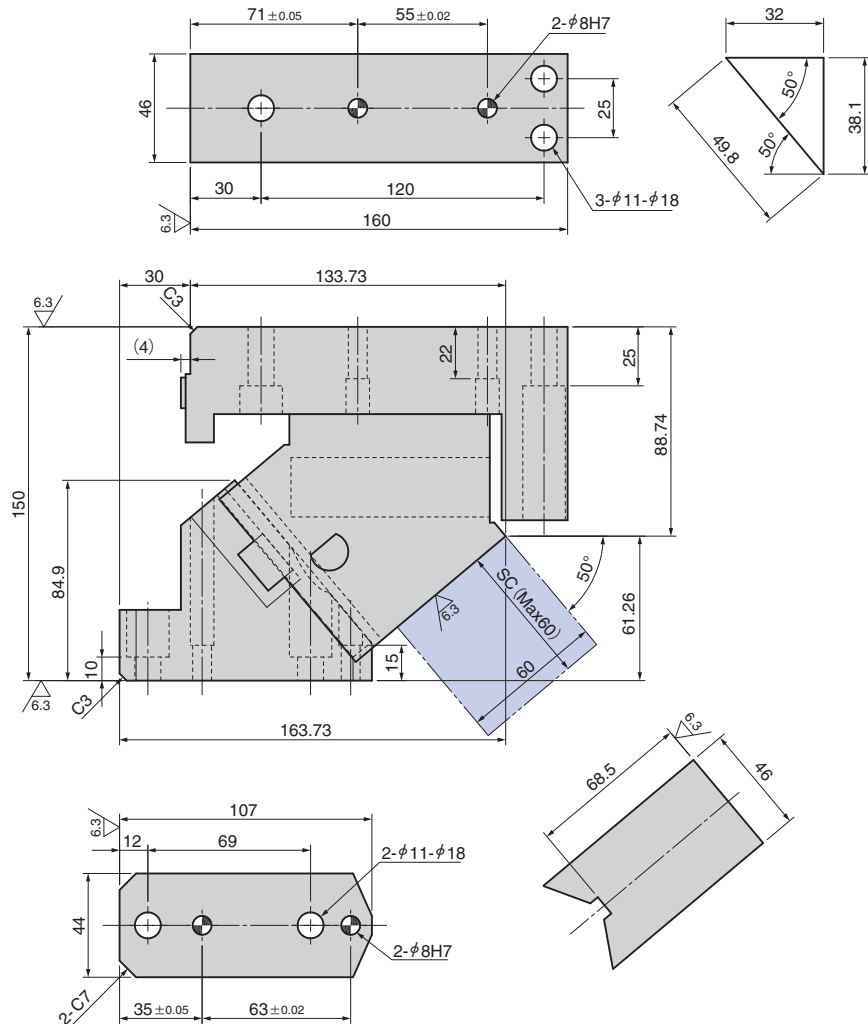

▶ 部品表P.391参照。